

LEGEND

- LANDS OWNERSHIP BOUNDARY
- SID APPLICATION SITE BOUNDARY
- PROPOSED DEVELOPMENT
- PROPOSED EIRGRID SECURITY FENCE
- x— PROPOSED EIRGRID POST & RAIL BOUNDARY FENCE
- PROPOSED BITUMINOUS ROAD SURFACE
- PROPOSED STONE SURFACE
- PROPOSED CONCRETE FOOTPATH
- PROPOSED EXTENT OF ASPHALT SURFACE
- PROPOSED LANDSCAPING
- WM— PROPOSED 38mmØ (PE 80 SDR 11) WM
- WM— PROPOSED 100mmØ (PE100 SDR 17) WM
- (H) PROPOSED FIRE HYDRANT
- (M) PROPOSED WATER METER
- [X] PROPOSED WM KIOSK
- SV PROPOSED SLUICE VALVE
- AV PROPOSED SLUICE VALVE
- [T] PROPOSED EXTERNAL TAP
- WM— EX. WATER

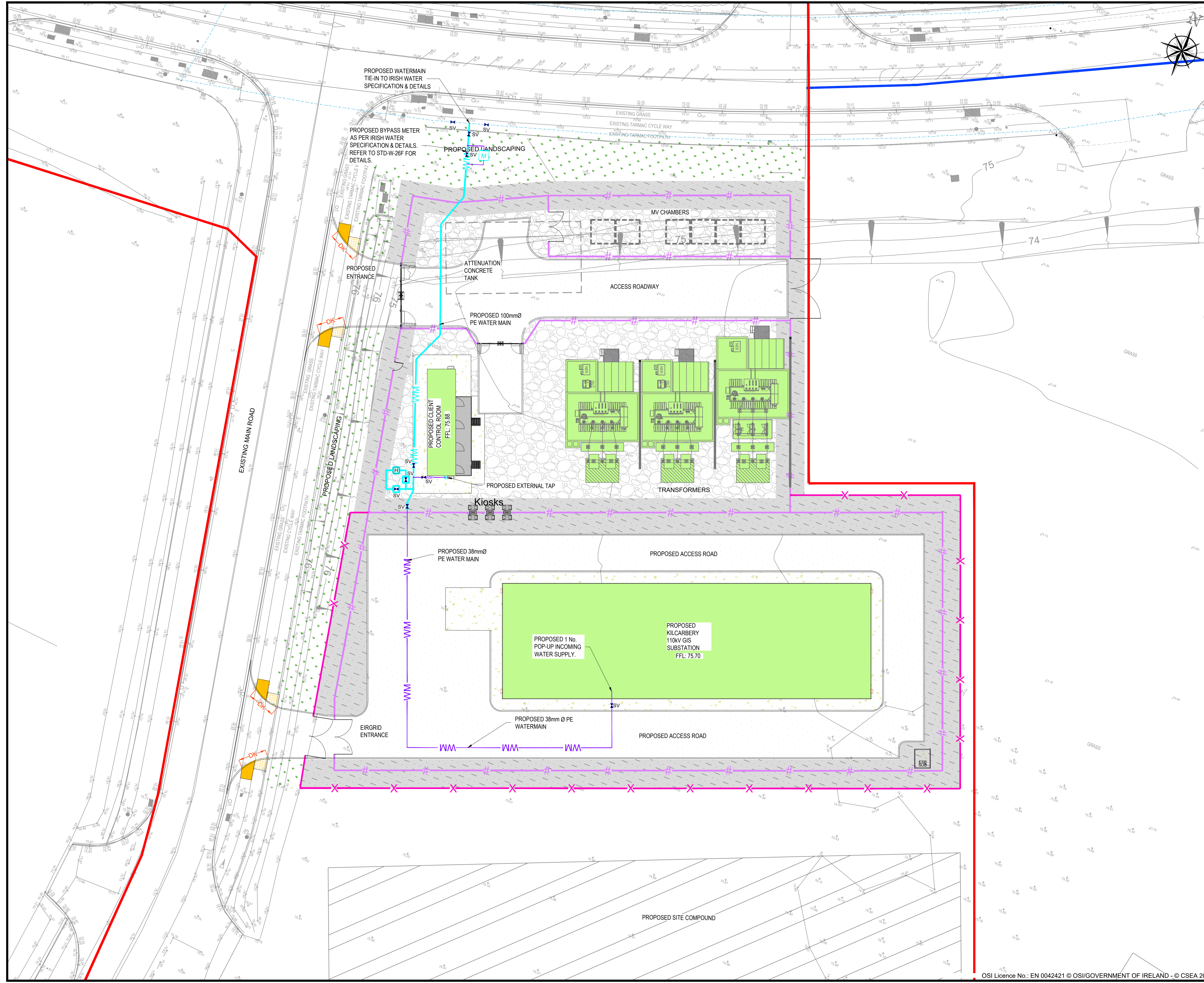

P04	SID ISSUE	DM	PM	04.02.2022
P03	DRAFT SID ISSUE	DM	PM	10.12.2021
P02	SID SCHEME ISSUE	DM	PM	26.11.2021
P01	WIP	DM	PM	22.10.2021
Rev	Description	Drawn	Checked	Date

Clifton Scannell Emerson Associates

Clifton Scannell Emerson Associates Limited
Consulting Engineers,
3rd Floor The Heights,
Bakers Point, Pottery Road,
Dun Laoghaire, Co. Dublin,
Ireland, A96 KW29

T: +353 1 288 5006
F: +353 1 283 3466
E: info@cseae.ie
W: www.cseae.ie

VANTAGE DATA CENTERS

Client: **KILCARBERY 110KV SUBSTATION & MV CLIENT COMPOUND**

Project: **PROPOSED & EXISTING WATERMAIN LAYOUT**

Dwg. Title: **PROPOSED & EXISTING WATERMAIN LAYOUT**

Drawn By: **DM** Date: **OCT 2021** **21_115**

Checked By: **PM** Scale: **1:250 @ A1** CSEA Job No.

Project Code: **21_115 - CSE - 00 - XX - DR - C - 2130**

Status Code: **S2** Suitability Description: **PRELIMINARY**

Revision: **P04** Project Status: **PRELIMINARY**